

PCPL[®]
REDEVELOPING HOMES
REBUILDING COMMUNITIES

Live
the life you've
imagined

PCPL

NIRVANA
springs



*Known as Shree Santoshi Nagar CHSL.
Proposed name is Nirvana Springs.

A LOCATION THAT KEEPS YOU CLOSE TO EVERYTHING MALAD

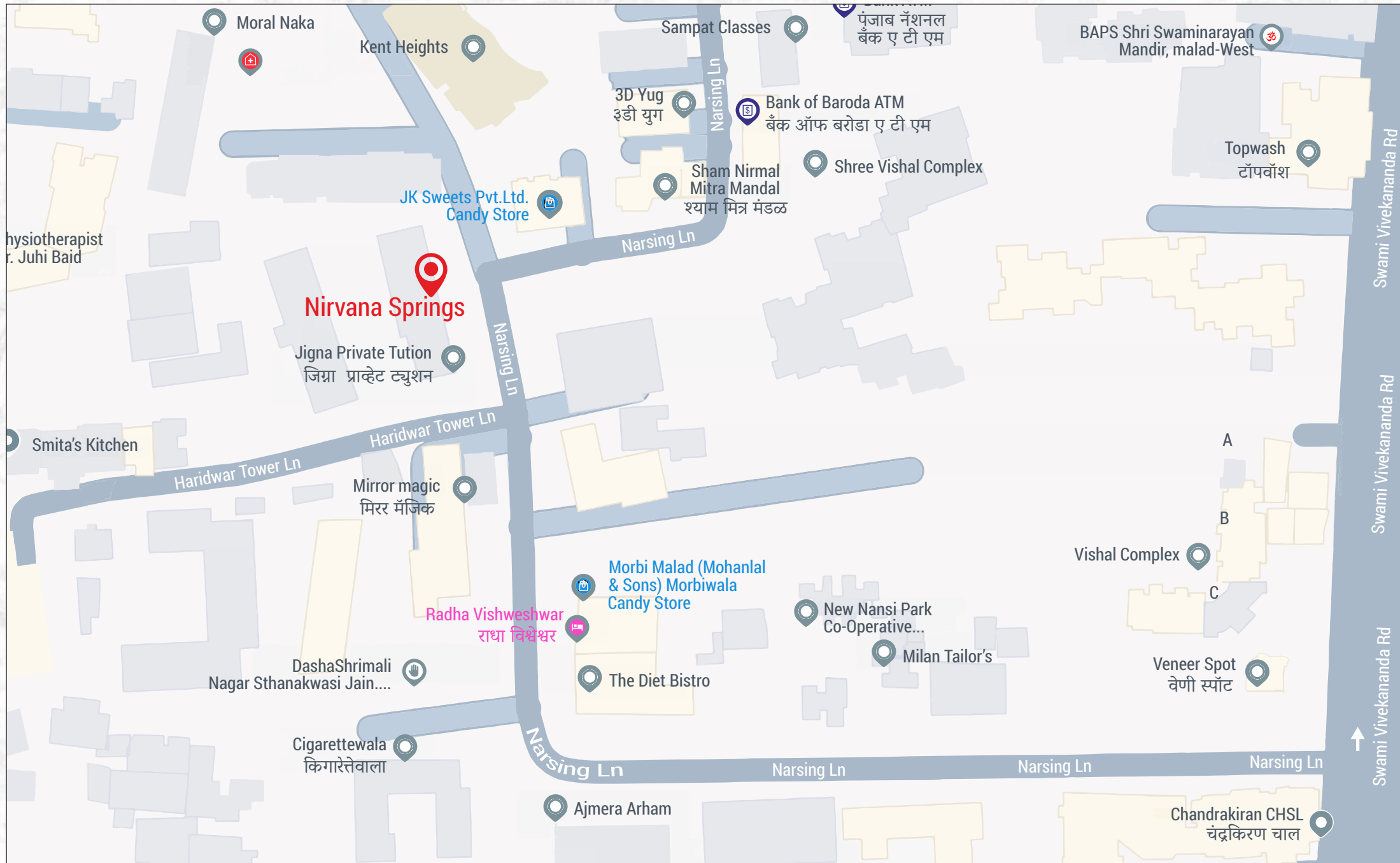

Nirvana Springs
Narsing Lane, Malad West, Mumbai - 400064

At the heart of every Pranav Constructions Limited project is our unwavering commitment to ethical practices and operational excellence. With every redevelopment we undertake, we ensure that each brick is built with trust, transparency, and respect for our community. Our focus extends beyond meeting timelines, as we prioritize fostering enduring relationships with our homeowners and stakeholders. We are more than builders; we are partners in progress. We plan for your tomorrow, so you can live your today carefree.

Our journey is driven by a core belief: true success is measured by the trust we cultivate along the way, in addition to the projects we complete. Guided by a clear vision to provide exceptional customer satisfaction, we invest in long-term relationships, crafting spaces that enhance lives and raise living standards.

Where joy and harmony come together for those
with plenty of anecdotes and tales to share.

SENIOR CITIZENS AREA



Find purpose in life with a tranquil space
that fosters wellness and peace.

YOGA DECK

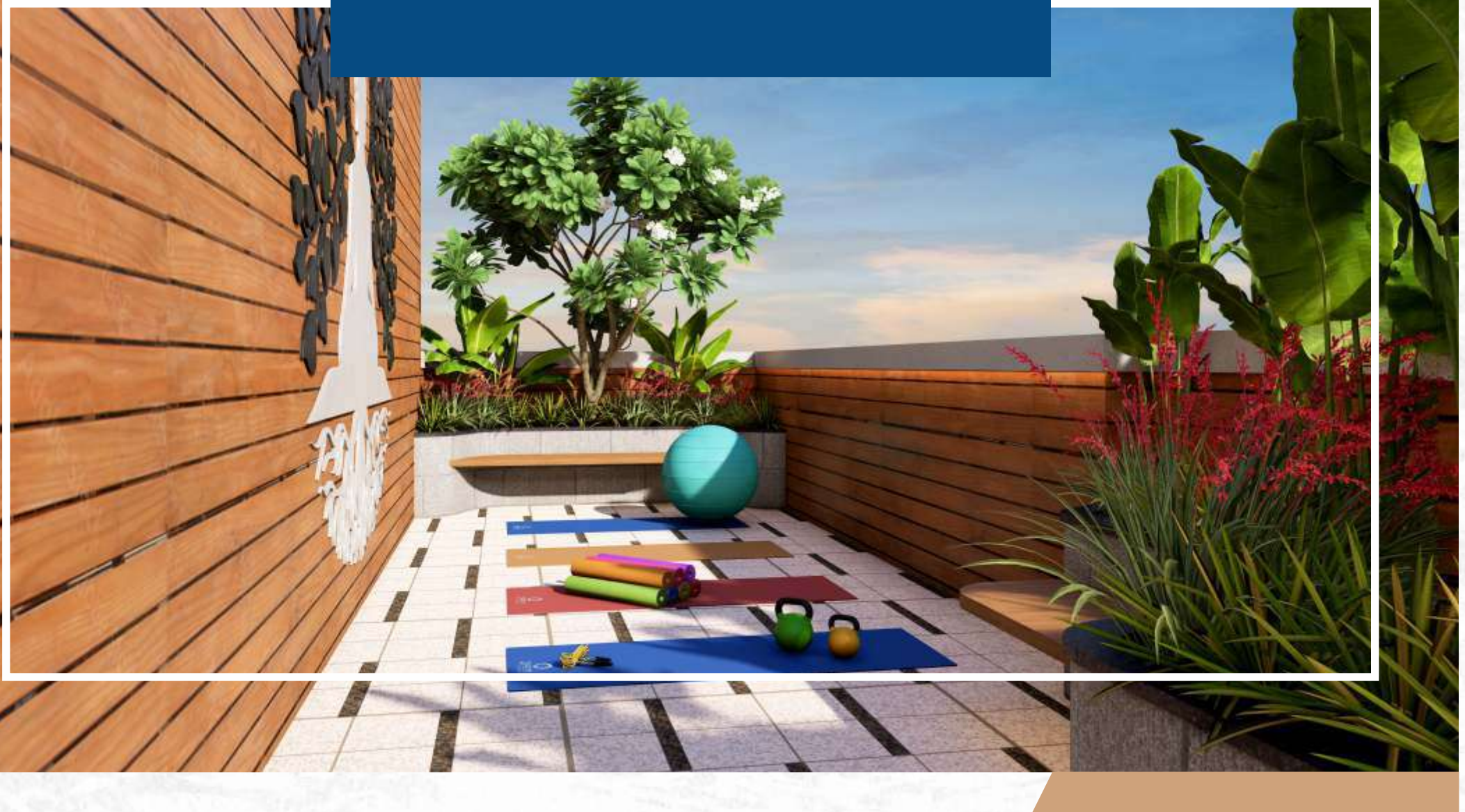

Celebrate the good times in the backdrop
of a view that's serene and spectacular.

PARTY AREA

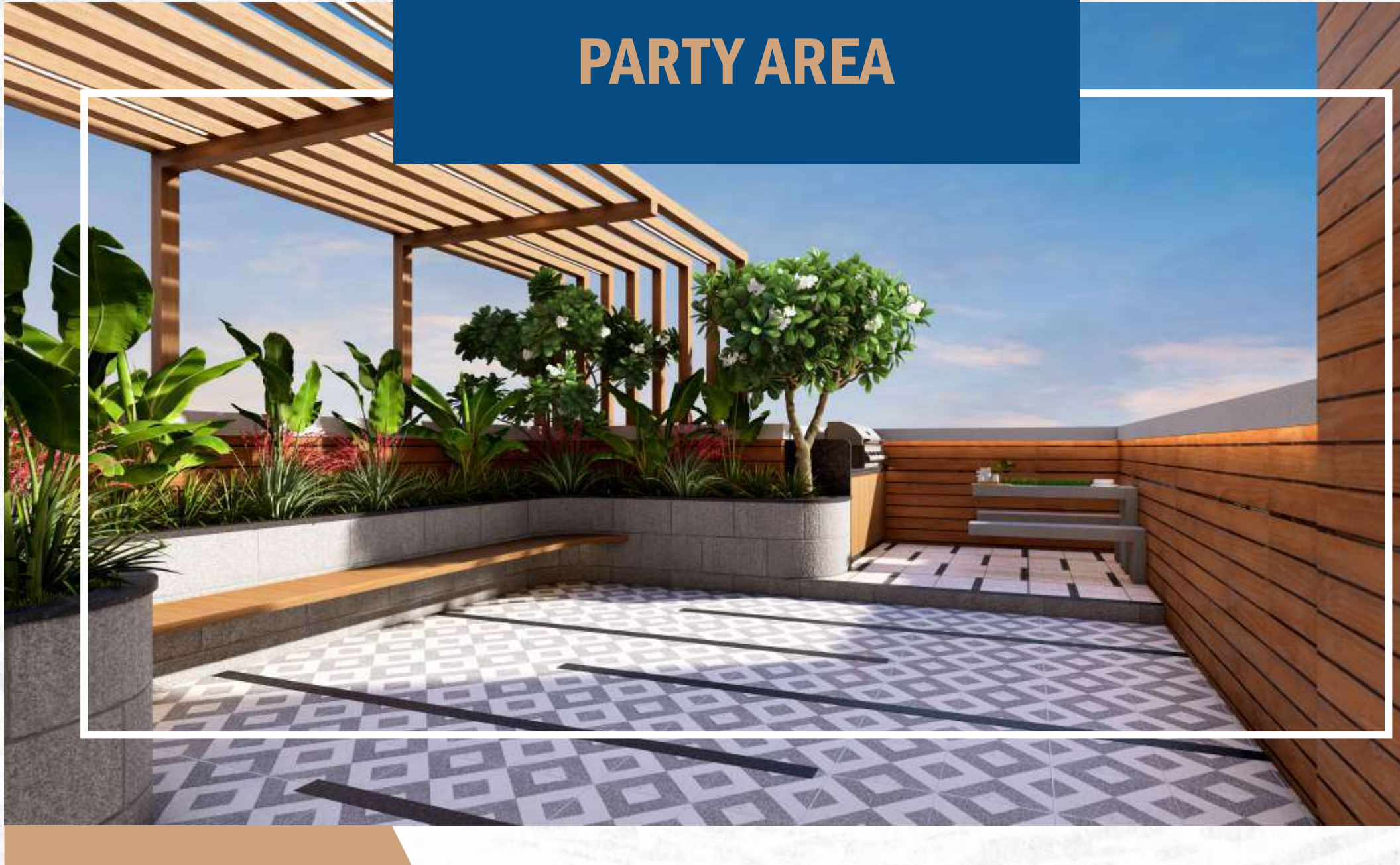

A bright and fun zone for the little kids
to play, grow, and explore.

TODDLERS PLAY AREA



A serene walking track that offers a peaceful, rejuvenating path for daily rounds.

WALKING TRACK

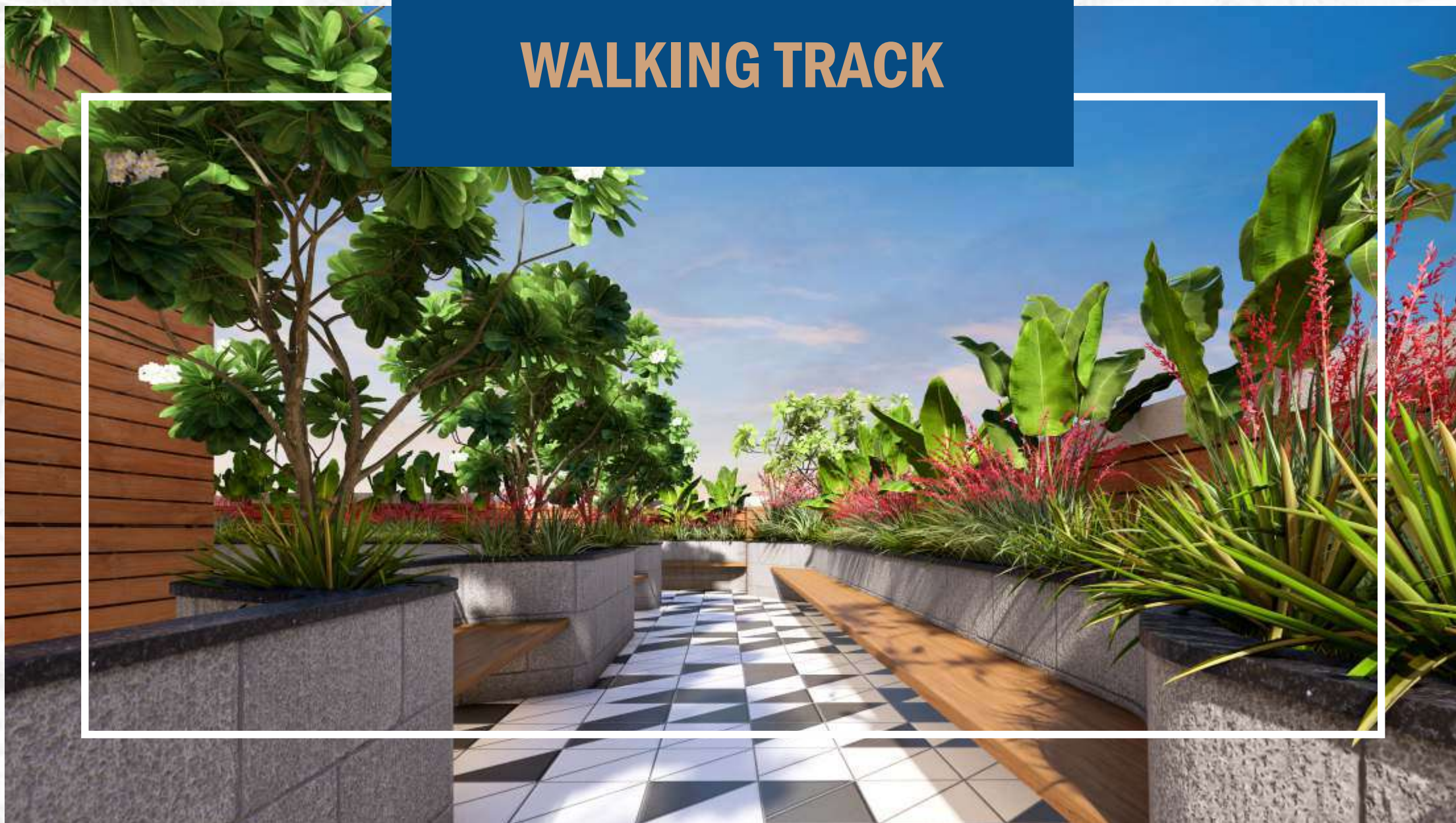

Access all the modern equipment one needs to stay fit.
It is fully equipped to support your fitness routine.

GYMNASIUM

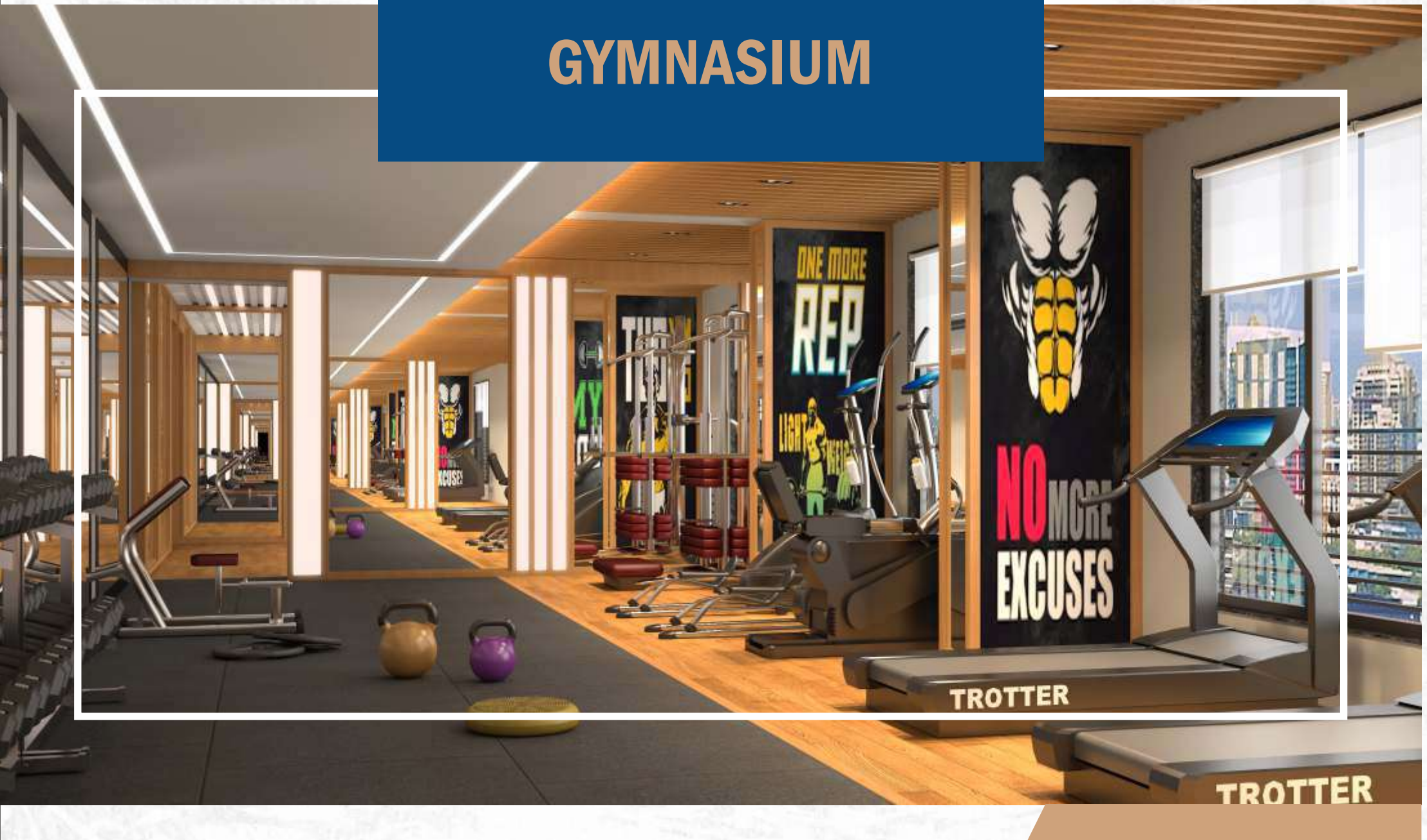

LIVING ROOM



MASTER BEDROOM

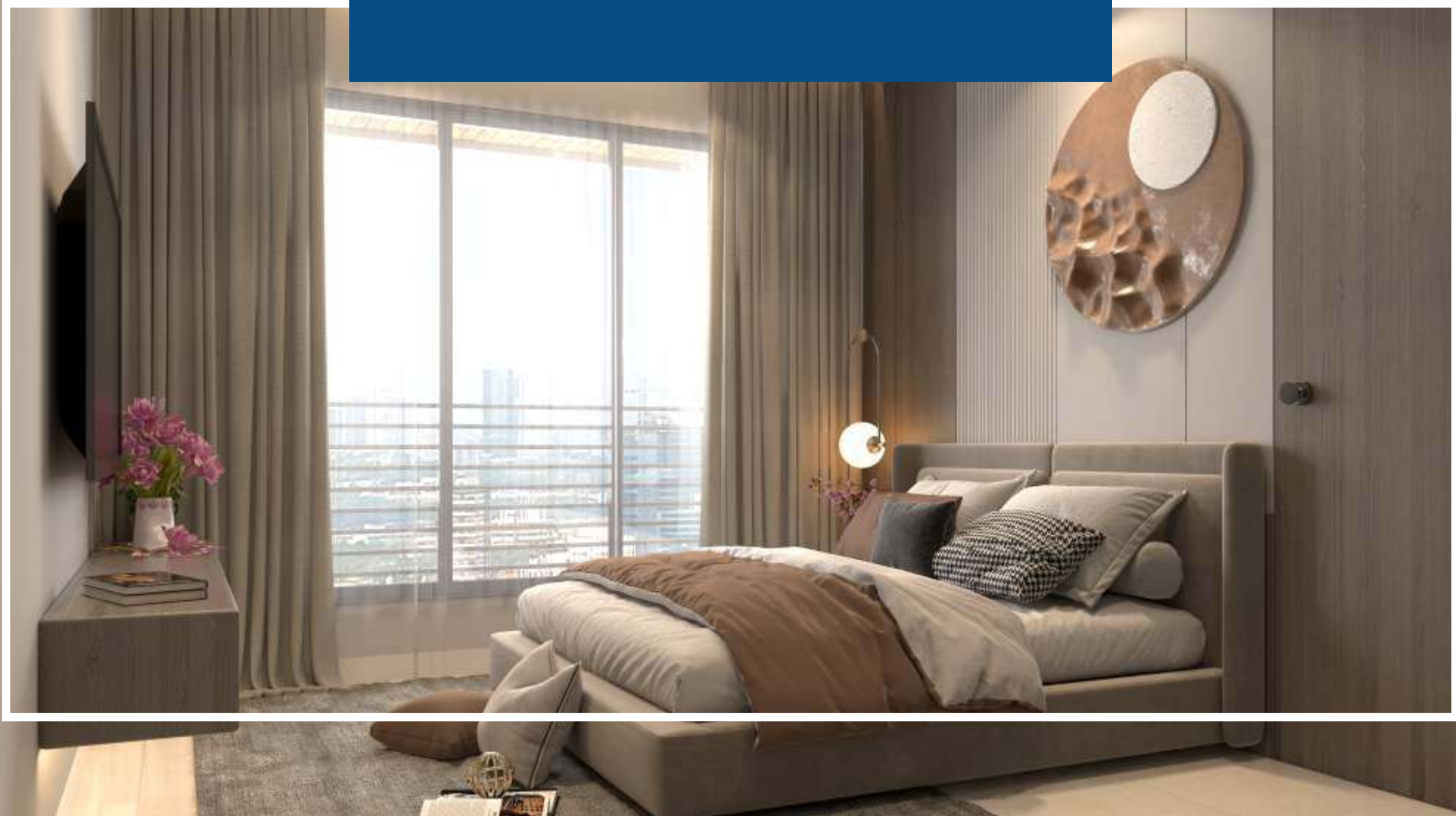

Images for representational purposes only

TYPICAL FLOOR PLAN



The plans are subject to change by the local authorities.
The drawings are not to scale.



GROUND FLOOR PLAN



The plans are subject to change by the local authorities.
The drawings are not to scale.



TERRACE GARDEN PLAN



← 44'0" FEET WIDE EXISTING ROAD →

The plans are subject to change by the local authorities.
The drawings are not to scale.



ISOMETRIC VIEW



2 BHK

The plans are subject to change by the local authorities.
The drawings are not to scale.



MAHARERA NO: PM1180002500245

This project has been registered with
MahaRERA under name of Redevelopment
of Shree Santoshi Nagar CHSL, available on
<https://www.maharera.maharashtra.gov.in>



1001, DLH Park, 10th Floor, SV. Road,
Opp. Goregaon MTNL, Goregaon (W), Mumbai - 104

☎ +91 91378 54811 / 022 62769977 | 🌐 www.pranavconstructions.com

This property is mortgaged with Aditya Birla Housing Finance Limited. The No Objection Certification (NOC)/ permission
of the mortgagee Bank would be provided for sale of flats / units / property as and when required.
Project approved and financed by Aditya Birla Housing Finance Ltd. Conditions apply.