



**NIRVANA**  
RESIDENCY

A Lifetime of *Peace*



A Lifetime of *Peace*

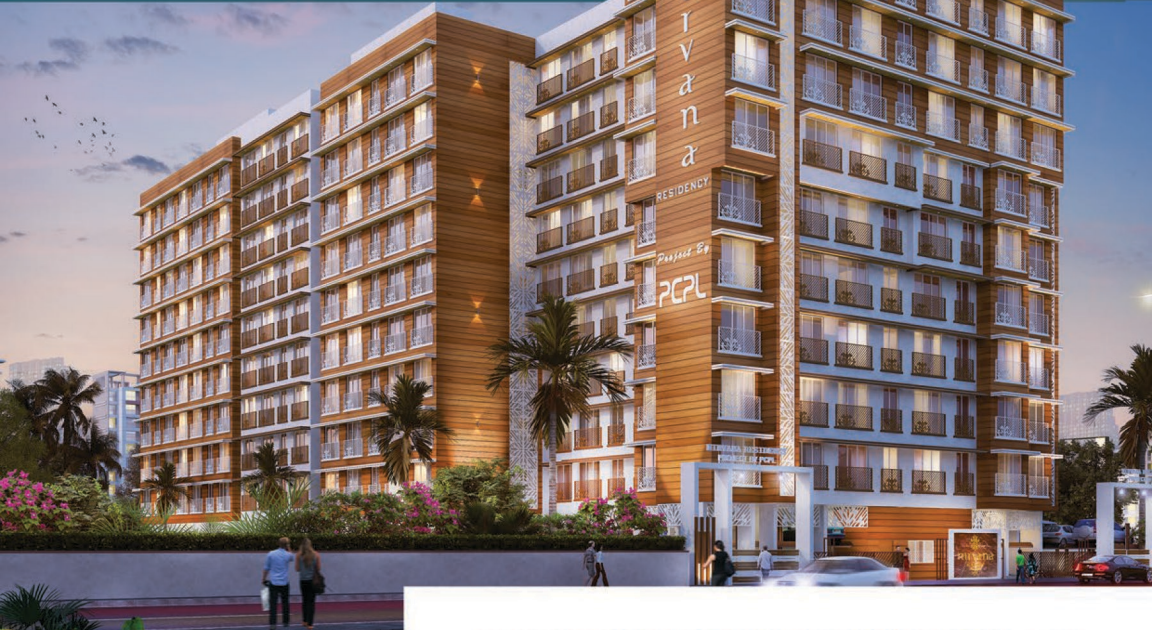

[WWW.PRANAVCONSTRUCTIONS.COM](http://WWW.PRANAVCONSTRUCTIONS.COM)



## ABOUT PCPL

Experience Peace. Experience Nirvana.

Experience PCPL's latest offering in Malad West.

The project boasts of exclusively designed 1, 2 & 3 BHK living spaces. Nirvana by PCPL is ideally located close to temples, banks, education institutions & hospitals and with easy connectivity to SV. Road, Link Road, Metro and Malad railway station makes Nirvana an ideal residential solution in the busy suburb of Malad.

The amenities include a Gymnasium, Indoor Kids Area, Solar Panel, Party Area, Acupressure Pathway, Meditation Deck and Zen Garden. Your perfect companion for peaceful living.

# Amenities



## Gymnasium

Sweat it out and feel the adrenaline rush at the well equipped gymnasium at Nirvana.



## Indoor Kids Area

Fun, safe and creative play environment for young minds. Indoor play areas are great alternatives to outdoor playgrounds for children to play in throughout the year.



## Solar Panel

Solar panels are installed to save on energy costs and also to preserve nature.



## Party Area

No need to move out for those large family get - togethers. Partying is now at your doorstep.



## Acupressure Pathway

Enjoy walks with acupressure pathway created to help stimulate positive energy and relaxation.



## Meditation Deck

Yoga improves your overall well-being. Living healthy is now convenient too with the meditation deck at Nirvana.



## Zen Garden

A zen garden is a great way to reduce stress, improve your focus, and develop a sense of peace.

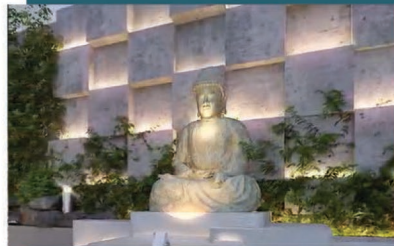



# Flat Configuration

**2366.10 sq.mt**  
Plot Area

- 1 BHK** : 424 Sq. ft
- 2 BHK** : 638 to 691 Sq. ft
- 3 BHK** : 832 to 898 Sq. ft



# Location Map

# Location Salience

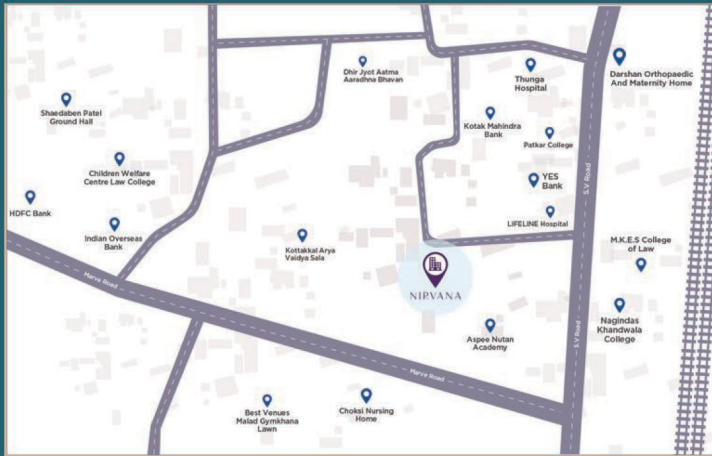

Address: Nursing Lane, Malad (West), Mumbai - 64.



**BANK**

15m

**HOSPITAL**



200m

**NARAYAN  
TEMPLE**



350m

**N.I. COLLEGE**



300m

**MALAD RAILWAY  
STATION**



1.7m





# A Lifetime of *Peace*

**PCPL**  
REDEVELOPING HOMES  
REBUILDING COMMUNITIES

 **022-62769927 / 77**

Follow Us:  /WeArePCPL  /WeArePCPL  @WeArePCPL

Site Address: Nursing lane, Malad (W), Mumbai - 400064.

Corporate Office: 1001, DLH Park, 10th Floor, SV. Road, Opp. Goregaon  
MTNL, Goregaon (W), Mumbai - 400062.

MahaRERA: P51800032468



SCAN To Download The App

This project is funded by **Bajaj Housing Finance Limited**